

# DG COMMONS

Professional

*Leases Starting at \$500/Month*

## Love Where You Work.

### Sleek New Modern Office Suites

- All Utilities Included In Rent
- Speed CAT 6 In Each Office
- On-Site Parking - Non-Exclusive, First Come Basis
- Shared Reception/Waiting Area
- Shared Lounge/Casual Meeting Space
- Sound Proof Insulation Between Office Suites
- Affordable Lease Terms Starting From \$500/Month.



*Steps from the Metra Train Station in vibrant Downtown Downers Grove;  
Surrounded by restaurants, coffee shops, social bars, entertainment, bus & train station, parks and theaters.*

**Downtown Downers Grove**

**Professional Office Community Coming Summer 2024**



“Be true to your work, your word, and your friend.”

— HENRY DAVID THOREAU



**FIRST FLOOR SUITES**

- SHARED BREAK AREA
- SHARED / PRIVATE BATHROOMS
- SHARED OUTDOOR PATIO

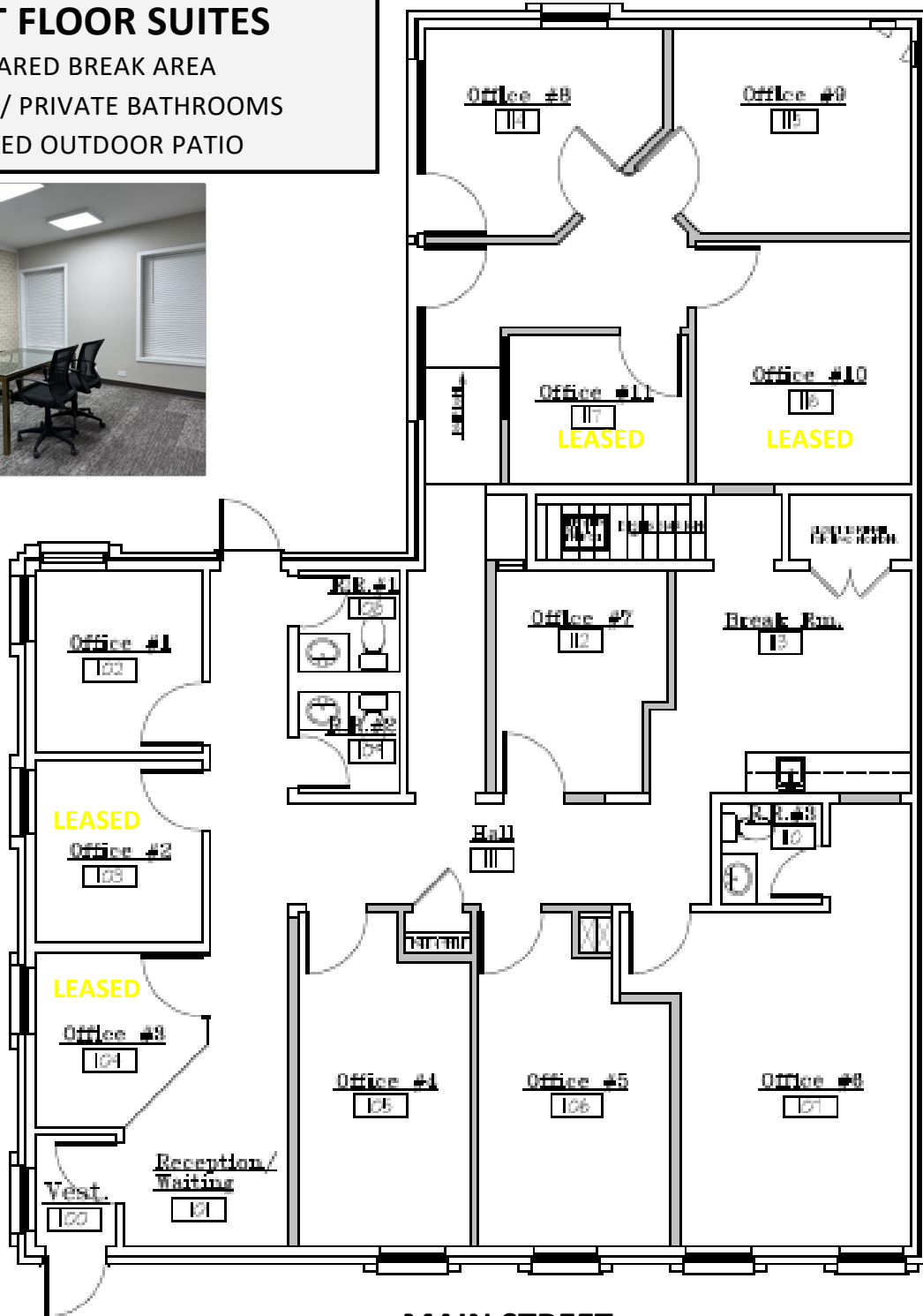

**MAIN STREET**

**LOWER LEVEL SUITES**

